



Workplace
Pathogen Protection Program™



Creating Layers of Defense:

- ▶ Cognitive psychologist James T. Reason's metaphor of layers of protection imagined as cheese slices, blocking the spread of COVID-19 made a lot of sense to a Canadian environmental technology company, Sparta Group, so they developed a system that included multiple layers of protection with workers in mind.
- ▶ The Swiss Cheese metaphor: No *ONE* layer is perfect because it has holes, but several layers combined can significantly reduce risk.

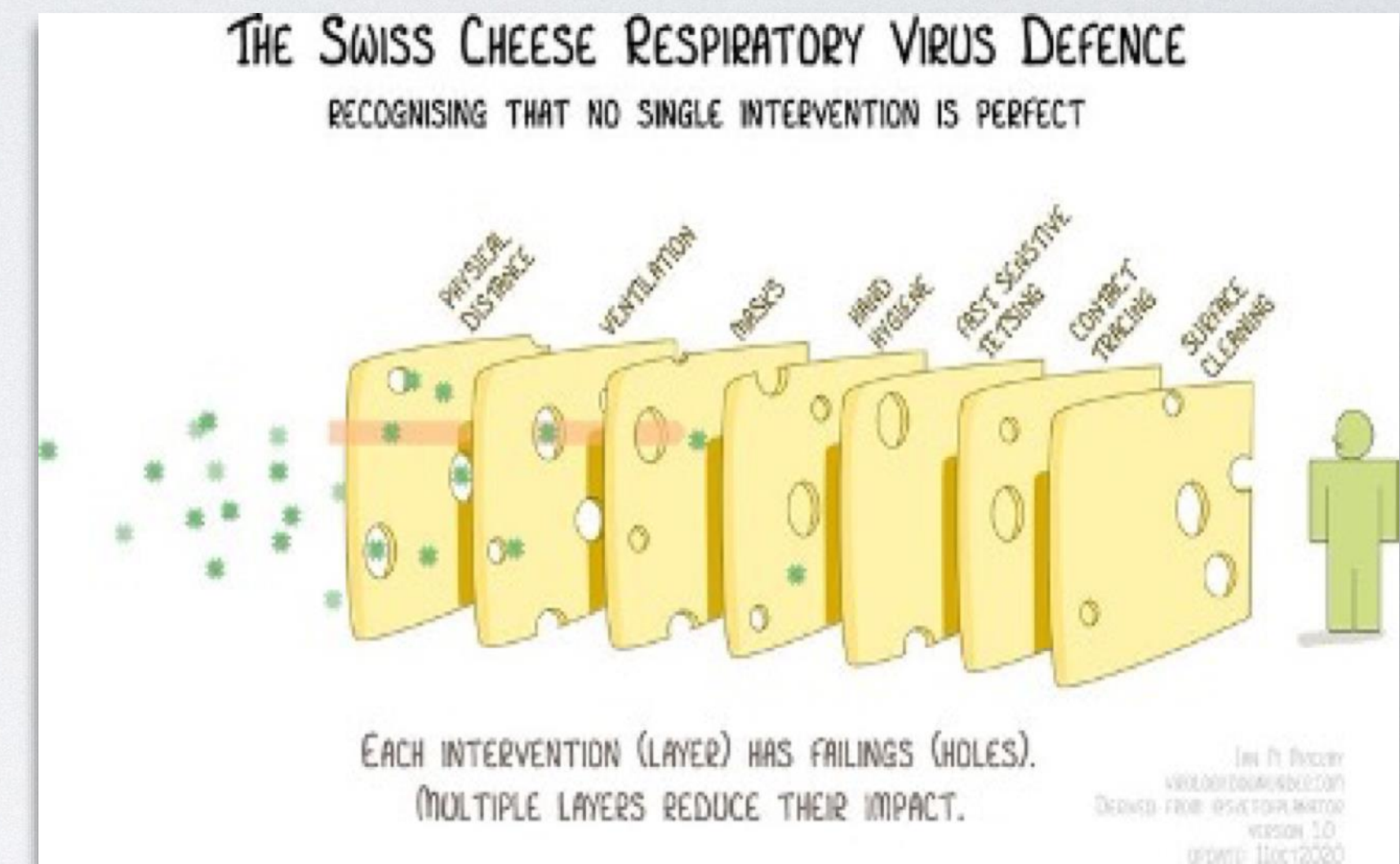

**Workplace
Pathogen Protection Program™**

Sparta Pathogen Protection Program™

5 distinct components (layers)

While Governments and society-at-large are largely banking on vaccines as the holy-grail, such a program represents only one layer of protection; especially in light of emerging variants. As a complement, to help make our employees feel safe, this program includes;

5 distinct layers of protection; thus greater Peace-of-mind;

1. Workplace Entry™ Station #1. (Safe Entry™ screening)
2. Workplace Entry™ Station #2. (disinfecting)
3. @Work by Achu Health™ mobile app with Employer Dashboard.
4. 2-part, COVID-19, point-of-use, rapid-testing.
5. Robotic antimicrobial dispersion system with 30-day pathogen protection for exposed surfaces.

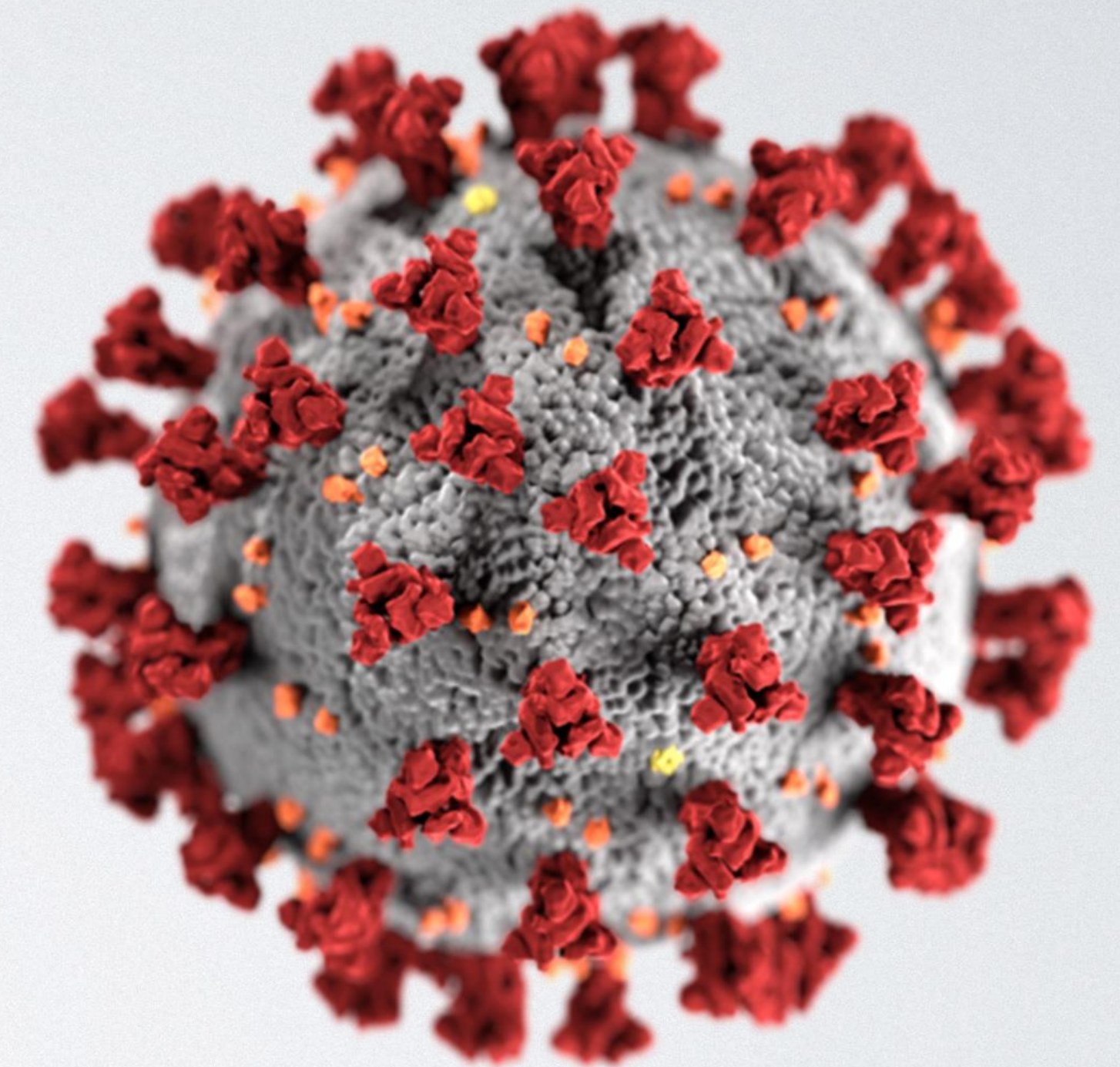

**Workplace
Pathogen Protection Program™**



Workplace Entry™ Station #1 (COVID-19 Safe Entry™ Screening)

- ▶ As workers and visitors enter the premises, they pass through this small screening station. It screens for a host of symptoms that may be associated with a disease like COVID-19. It scans for such things as fever, exhaustion, cough, congestion, redness of eyes, activeness of sweat glands etc.
- ▶ If a red light goes on, it means potential illness and they proceed to nurse's station for testing.
- ▶ If a green light goes on, they proceed to station #2.



**Workplace
Pathogen Protection Program™**

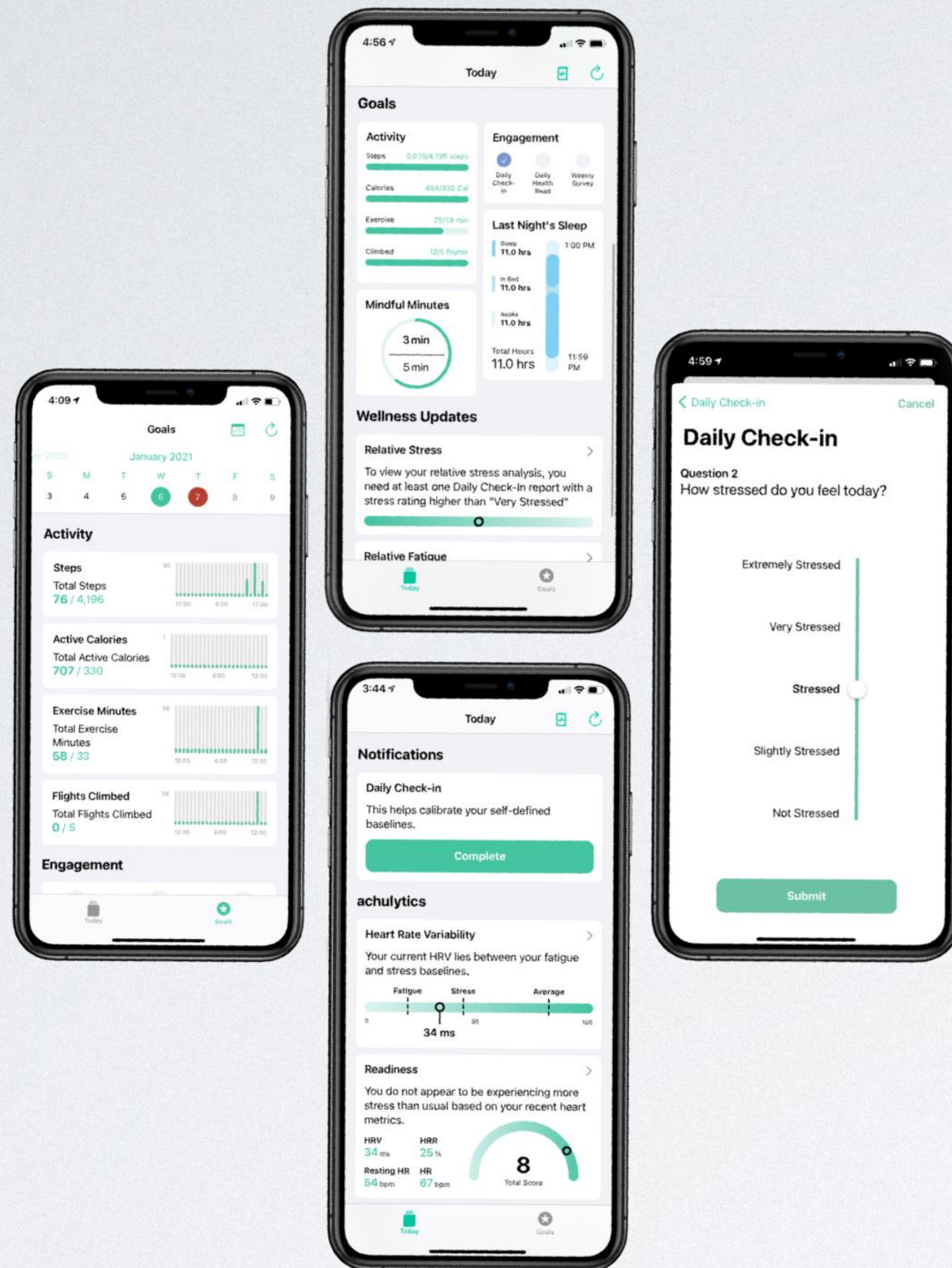

If Workplace Entry™ Station #1 and employee reporting does NOT report any symptoms

- Automatically categorized as a 'Cleared' employee.



Workplace Entry™ Station #2 (HOCl Protection)

- ▶ As a worker or visitor walks through screening station #2, they are lightly exposed to a specially formulated, non-toxic, HOCl based antimicrobial mist. It is safe for clothing, human skin, and human consumption, as it utilizes the same active molecule (HOCl) as the body's white blood cells.
- ▶ Once passed through the mist, workers or visitors can enter the workspace.



**Workplace
Pathogen Protection Program™**



@Work by Achu Health™ is a system with a centralized dashboard



Each employee is connected to the dashboard through the app on their phone



Employers gain aggregated insights on the health of their organization so they can make informed decisions to promote a healthier workplace.

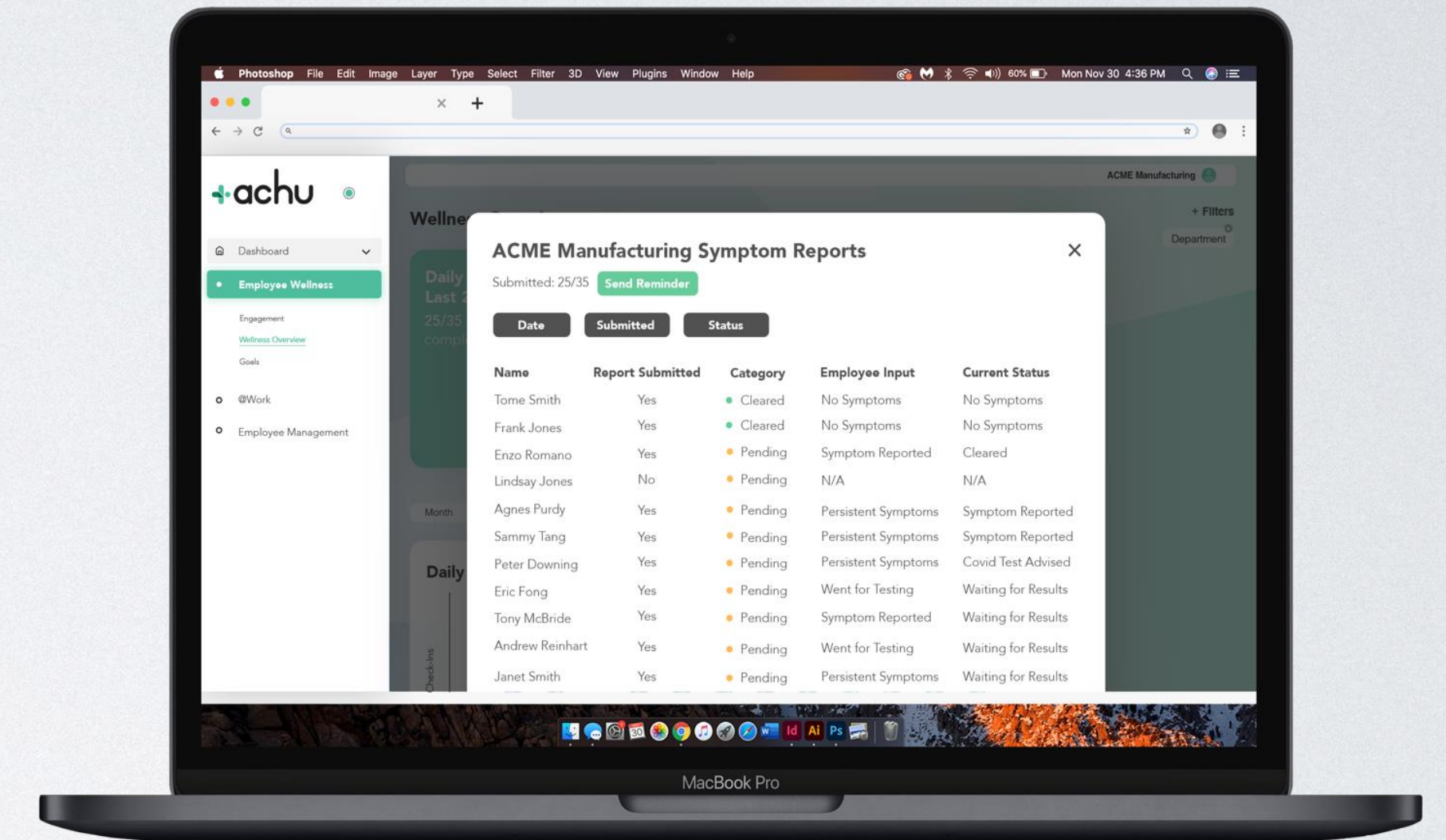

**Workplace
Pathogen Protection Program™**



@ Work Health App

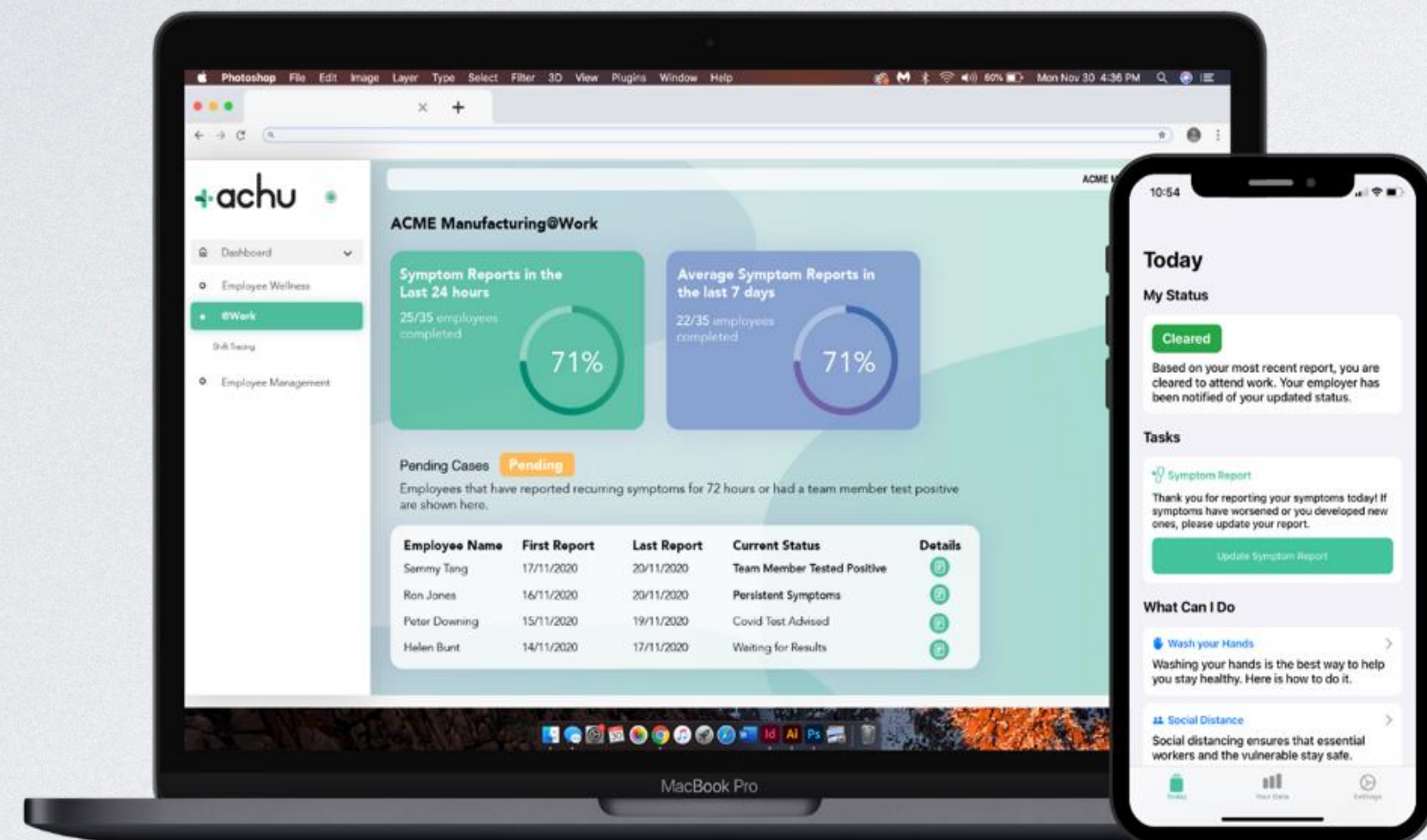

- ▶ All employees receive the @Work by Achu Health™ mobile app.
- ▶ Employees complete a daily symptom report, including a Dysantz™ temperature scan, to determine eligibility for work that day.
- ▶ System does *not* track location of any kind. By employees simply reporting their symptoms prior to entering their workplace, business can better protect the health of all employees.
- ▶ Private and secure solution – prioritizing employee privacy every step of the way.



**Workplace
Pathogen Protection Program™**

- ▶ If an employee reports symptoms or a high temperature, they are entered into the 'Pending' category and sent for further testing.
- ▶ The 'Pending' employee will receive a notification of their status, and it will be automatically updated on the connected dashboard.
- ▶ 'Pending' employees will be sent to nurse's station for a rapid antigen test; possibly followed by a rapid antibody test, depending on the results.
- ▶ If employee shows no symptoms or fever, they will be placed in 'Cleared' category on the dashboard and are eligible to work.
- ▶ If there is a possible exposure risk, anyone who may have come in contact with the infected employee will receive an automatic exposure notification to their mobile device.

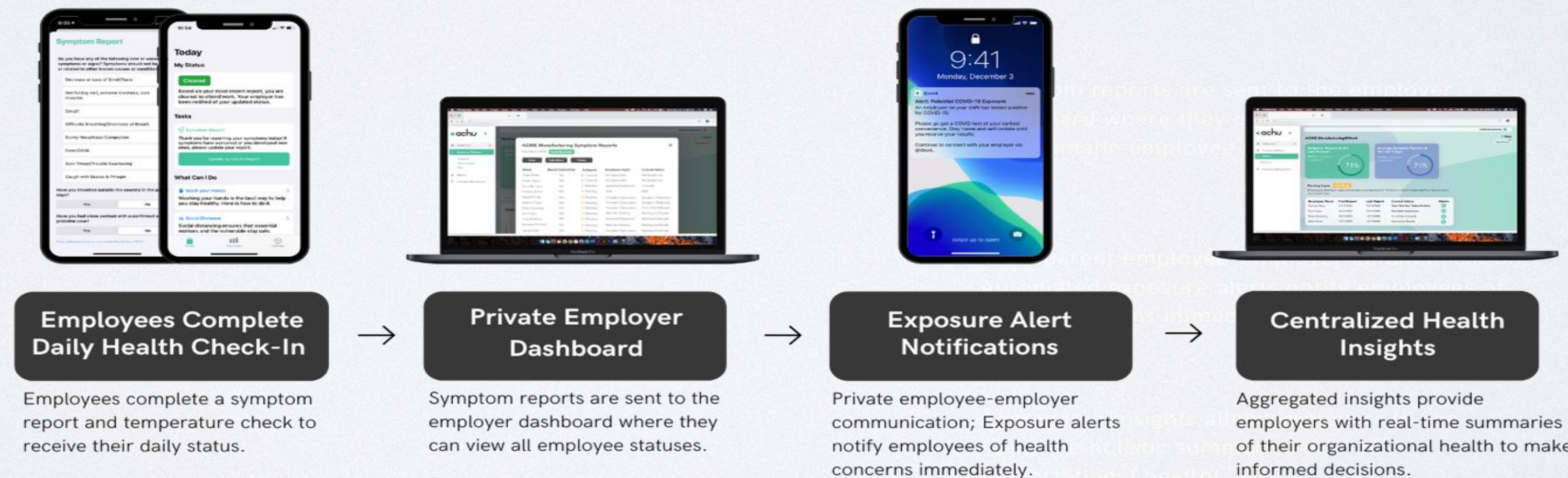

Workplace Pathogen Protection Program™

Antigen Test



Antibody Test



Testing

- ▶ Sparta provides employers with point-of-use, rapid-test kits, for both antigen and antibody testing; to be administered by qualified healthcare professionals.
- ▶ When flagged as 'Test pending', depending on the diagnosis, the employee will be provided with an appropriate antigen test at the nurse's station, to determine if the antigen, such as the one related to the SARS-CoV-II virus is present.
- ▶ If the employee happens to test positive for the SARS-CoV-II antigen, they will be instructed to go to a local Government regulated healthcare facility for a confirmation COVID-19 PCR test.

Testing (cont'd)



- ▶ If employee tests negative, the health-care professional will administer a complimentary serology-based antibody test to determine if the employee has been “*exposed*” to the related virus, such as SARS-CoV-II.
- ▶ If the employee tests positive to the antibody test, a 2nd antigen test will be administered.
- ▶ If the 2nd antigen test proves negative, the employee can go back to work and is provided with information to take back to his/her family.
- ▶ If the employee tests positive to the 2nd SARS-CoV II antigen test, he/she will be instructed to go to a local Government regulated healthcare facility for a confirmation COVID-19 PCR test.



**Workplace
Pathogen Protection Program™**



Robotic Pathogen Protection Dispersion

- ▶ Robotic antimicrobial dispersion in workspaces, including offices and factory floors
- ▶ Health Canada approved formulation provides mechanical-kill pathogen protection for all contacted surfaces, lasting up to 30 days
- ▶ Free of off-gassing toxins, thus microbe discriminant
- ▶ Safe for all surfaces
- ▶ Compounds are FDA, EPA and Health Canada registered
- ▶ Adding additional peace-of-mind for employees in a post-pandemic world.



**Workplace
Pathogen Protection Program™**



a member of Sparta Group,
a publicly listed company on the
TSX Venture Exchange
under the symbol "**SAY**"
(TSX.V: SAY)

www.spartagroup.ca

